

Cable Breakout Unit

The Miniflex Cable Breakout Unit (CBU) affords quick and easy arrangements of the fibres or cable elements of multi fibre cables, which are sheathed in Miniflex Optical Fibre Protection Tubing (OFPT) to give permanent protection. The CBU is used at distribution points such as a junction cabinet to separate and manage individual cable element tubes or fibre bundles. Each cable or fibre bundle is sheathed in the Miniflex OFPT whose grooves match the notches in the CBU so that they can be slotted firmly and securely into place.

The CBU provides a robust fibre management system that minimises installation time and maximises fibre integrity and security. It provides a strong anchorage point and a neat lay-through for OFPT.

Miniflex CBU is used at distribution points where multi-fibre cables need to have the vulnerable individual fibres or cable elements separated and protected by a management system. It can be used with the Miniflex Gland Box shown above (bottom right inset photo) for further protection and mechanically anchoring the gland.

Application

Used in Splice Joint Housings, Racks and other fibre network infrastructure for cable breakout & retention and subsequent protected circuit routing in OFPT, or used in conjunction with the Miniflex Gland Box for a standalone solution that provides a gas block-able cable breakout using a suitable pour-in potting compound.

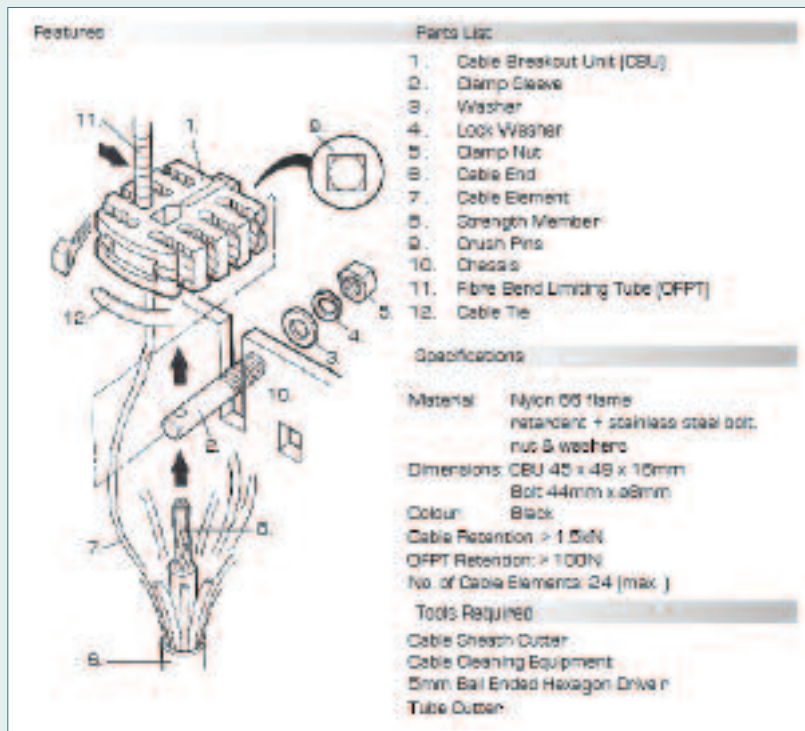

Ordering Information for Cable Breakout Unit

Part Number	Description
CBU-05-24-BLK-M8	24-Way Cable Breakout Unit with M8 Bolt
CBU-05-24-BLK	24-way CBU body only

See also OFPT datasheet for complimentary system components

Ordering Information for Gland Boxes

Part Number	Description
CBUGB-24.5-31.5-GRP	Cable Gland range ø24.5 to ø31.5
CBUGB-38-GRP	No Gland - maximum range ø38
CBUGB-25-17.5-GRP	Cable Gland range ø25 to ø17.5
CBUGB-18-13-GRP	Cable Gland range ø18 to ø13
CBUGB-13-9.5-GRP	Cable Gland range ø13 to ø9.5
CBUGB-10-7.5-GRP	Cable Gland range ø10 to 7.5
CBUGB-8.5-4.0-GRP	Cable Gland range ø8.5 to ø4.0

Features & Benefits

- Maximum of 24 cable elements or 24 fibre bundles
- Stainless steel bolt for secure fastening and Earth grounding to steel strength members
- Used with the Miniflex Gland Box to provide cable gland input to OFPT in up to 24 Output circuits
- Provides quick lay-thru retention with strain relief to OFPT
- A clamp sleeve facilitates attachment to a chassis

Key Data

Dimensions

L	H	D	d1	X	Y	d2
49	16	44	ø5	44	ø8	ø4.7

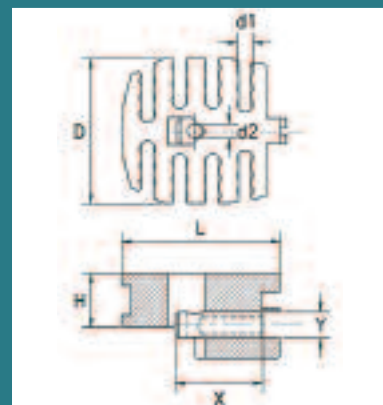

All dimensions in mm

- Material: FR Nylon + stainless steel bolt
- Colour: Black
- Cable retention: > 1.5KN
- OFPT retention: > 100N

This product is patented - Patent Number W095/22071

T: +44 (0) 1728 726600

E: enquiries@miniflex.co.uk

W: www.miniflex.co.uk

miniflex[®]
OPTICAL FIBRE PROTECTION SYSTEMS